

SCHEDULE OF DOORS & WINDOWS					
SL.NO.	TYPE	WIDTH	HEIGHT	NOS.	DESCRIPTION
1	D	1500	2400	2	DOUBLE PANEL WOODEN DOOR
2	D1	1200	2100	20	DOUBLE PANEL WOODEN DOOR
3	D2	750	2100	20	SINGLE PANEL WOODEN DOOR
4	W	1500	2100	11	STEEL FRAME GLAZED WINDOW
5	W1	1200	1200	22	STEEL FRAME GLAZED WINDOW
6	W2	900	1200	8	STEEL FRAME GLAZED WINDOW
7	W3	900	600	2	STEEL FRAME GLAZED WINDOW
8	W4	2500	1500	4	STEEL FRAME GLAZED WINDOW
9	S.W	1800	1500	1	SERVICE WINDOW
10	V	600	600	10	STEEL GLAZED VENTILATION
11	V1	1200	300	18	STEEL GLAZED VENTILATION
12	FGL	2200	2100	2	GLAZED VENTILATION
13	BFG	3000	2400	1	BI FOLD GRILL

GROUND FLOOR PLAN  
 AREA - 858.80 sqm (9240.69 sqft.)  
 (SCALE 1:75)

Drinking water provision done.  
 Pantaj Singh  
 11-7/12

BIHAR STATE EDUCATIONAL INFRASTRUCTURE DEVELOPMENT CORPORATION LTD.  
 SHIKSHA BHAWAN, SAIDPUR, PATNA

AHOZHI 11.7.18 DRAUGHTSMAN BSEIDC, PATNA	ARCH. BSEIDC, PATNA	SENIOR (ARCH.) BSEIDC, PATNA	C.E. BSEIDC, PATNA
PROJECT <b>PROPOSED CONSTRUCTION OF BOY'S HOSTEL FOR 100 STUDENTS (DIET, P.TEC, C.TE, BITE)</b>			
DEPT. <b>BIHAR STATE EDUCATIONAL INFRASTRUCTURE DEVELOPMENT CORPORATION LTD.</b> SHIKSHA BHAWAN, SAIDPUR, PATNA			
ARCHT. AND CONSULTANT  <b>RANCHI DESIGN &amp; CONSULTANCY SERVICES PVT. LTD.</b> SOUTH OFFICE PARA, NEAR ST. XAVIER SCHOOL DORANDA, RANCHI-834002			

NOTES:-  
 1. ALL DIMENSIONS AND LEVELS ARE IN mm. & FIGURED DIMENSIONS SHALL BE FOLLOWED.  
 2. ±0.00 LEVEL CORRESPONDS TO PLINTH LEVEL (P.L.) OF BUILDING, WHICH IS 600mm ABOVE FINISHED GROUND LEVEL (G.L.).

3. ALL RCC WORK SHALL BE OF M25 GRADE CONCRETE.  
 4. BRICKWORK SHALL BE WITH 100A BRICKS IN CEMENT MORTAR 1:6.

REV.	DESCRIPTION	DATE	BY
△	GENERAL REVISION	26.11.14	SUNIL
△	GENERAL REVISION	29.04.14	J.P

CHECKED & APPROVED	S.L.GOPE	<b>GROUND FLOOR PLAN</b>
DESIGN BY	SA.	
DRAWN BY	J.P.	
SIZE-	SCALE 1:75	DRG. NO.-RDCS/BSEIDC/D033/HOS/001
		SHEET 1 OF 4
		REV R=2

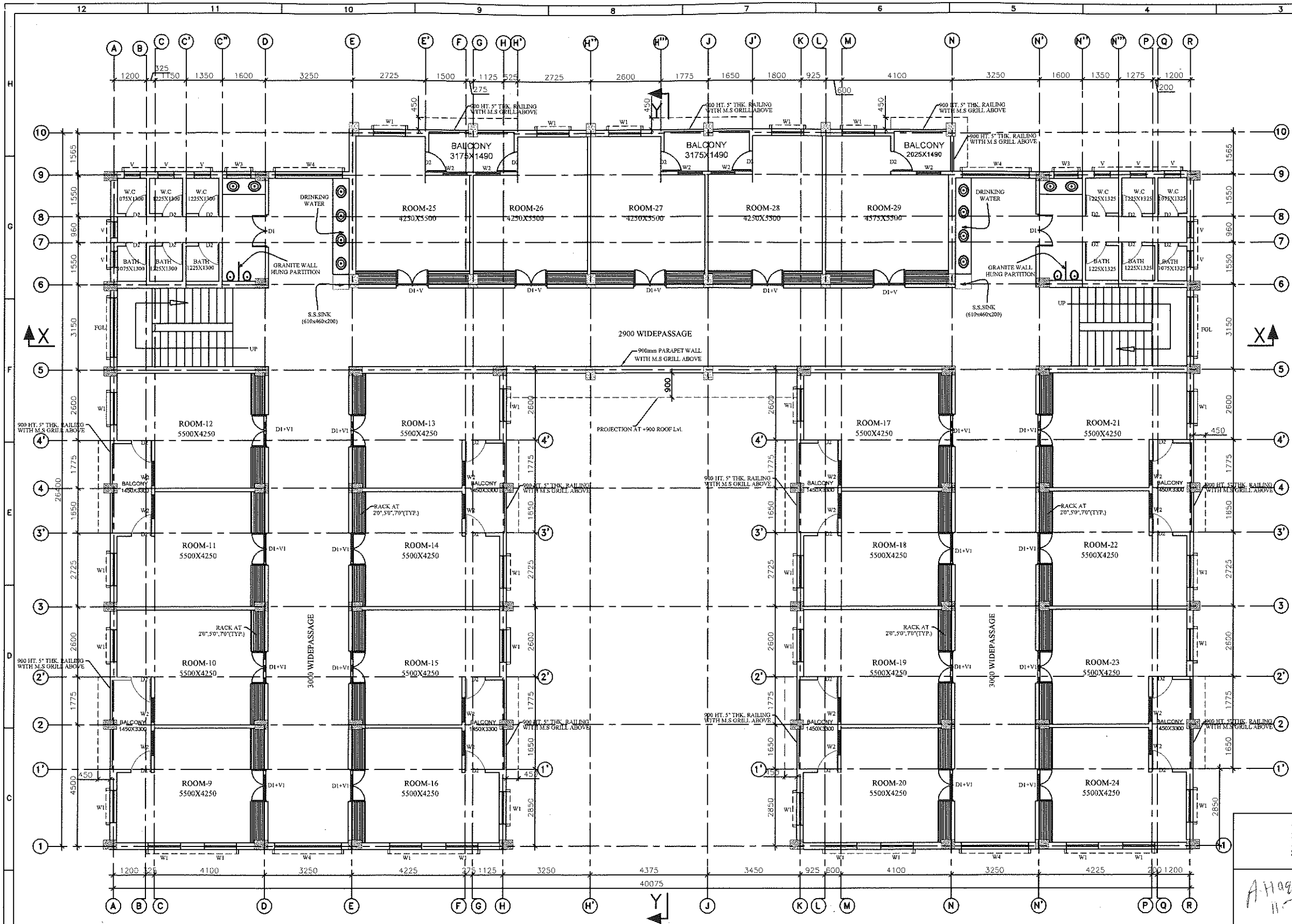

SCHEDULE OF DOORS & WINDOWS					
SL.NO.	TYPE	WIDTH	HEIGHT	NOS.	DESCRIPTION
1	D1	1200	2100	23	DOUBLE PANEL WOODEN DOOR
2	D2	750	2100	33	SINGLE PANEL WOODEN DOOR
3	W	1500	1200	8	STEEL FRAME GLAZED WINDOW
4	W1	1200	1200	21	STEEL FRAME GLAZED WINDOW
5	W2	900	1200	21	STEEL FRAME GLAZED WINDOW
6	W3	900	600	2	STEEL FRAME GLAZED WINDOW
7	W4	2000	1200	4	STEEL FRAME GLAZED WINDOW
8	V	600	600	10	STEEL GLAZED VANTILATION
9	V1	1200	300	21	STEEL GLAZED VANTILATION
10	FGL	2200	2100	2	GLAZED VANTILATION

**FIRST FLOOR PLAN**  
 AREA - 858.80 sqm (9240.69 sqft.)  
 (SCALE 1:75)

*Drinking water provision done  
 Parag Bhal  
 11-7-18*

**BIHAR STATE EDUCATIONAL INFRASTRUCTURE DEVELOPMENT CORPORATION LTD.**  
 SHIKSHA BHAWAN, SAIDPUR, PATNA

<i>Ahmad</i> 11-7-18	ARCH. BSEIDC, PATNA	<i>Parag Bhal</i> 11-7-18	C.E. BSEIDC, PATNA
draughtsman BSEIDC, PATNA		senior (arch.) BSEIDC, PATNA	

PROJECT	<b>PROPOSED CONSTRUCTION OF BOY'S HOSTEL FOR 100 STUDENTS (DIET, P.TEC, C.TE, BITE)</b>
DEPT.	<b>BIHAR STATE EDUCATIONAL INFRASTRUCTURE DEVELOPMENT CORPORATION LTD.</b> SHIKSHA BHAWAN, SAIDPUR, PATNA
ARCHT. AND CONSULTANT	<b>RANCHI DESIGN &amp; CONSULTANCY SERVICES PVT. LTD.</b> SOUTH OFFICE PARA, NEAR ST. XAVIER SCHOOL DORANDA, RANCHI-834002

**NOTES:-**  
 1. ALL DIMENSIONS AND LEVELS ARE IN mm. & FIGURED DIMENSIONS SHALL BE FOLLOWED.  
 2. ±0.00 LEVEL CORRESPONDS TO PLINTH LEVEL(P.L.) OF BUILDING. WHICH IS 600 ABOVE FINISHED GROUND LEVEL(G.L.).

3. ALL RCC WORK SHALL BE OF M25 GRADE CONCRETE.  
 4. BRICKWORK SHALL BE WITH 100A BRICKS IN CEMENT MORTAR 1:6.

REV.	DESCRIPTION	DATE	BY
△	GENERAL REVISION	26.11.14	SUNIL
△	GENERAL REVISION	29.04.14	J.P

CHECKED & APPROVED	S.L.GOPE	<b>FIRST FLOOR PLAN</b>
DESIGN BY	S.A	
DRAWN BY	J.P.	
SIZE-	SCALE 1:75	DRG. NO.-RDCS/BSEIDC/0033/HOS/001
		SHEET 2 OF 4
		REV R=2

SCHEDULE OF DOORS & WINDOWS					
SL.NO.	TYPE	WIDTH	HEIGHT	NOS.	DESCRIPTION
1	D1	1200	2100	23	DOUBLE PANEL WOODEN DOOR
2	D2	750	2100	33	SINGLE PANEL WOODEN DOOR
3	W	1500	1200	4	STEEL FRAME GLAZED WINDOW
4	W1	1200	1200	21	STEEL FRAME GLAZED WINDOW
5	W2	900	1200	21	STEEL FRAME GLAZED WINDOW
6	W3	900	600	2	STEEL FRAME GLAZED WINDOW
7	W4	2500	1200	4	STEEL FRAME GLAZED WINDOW
8	V	600	600	10	STEEL GLAZED VENTILATION
9	V1	1200	300	21	STEEL GLAZED VENTILATION
10	FGL	2200	2100	2	GLAZED VENTILATION

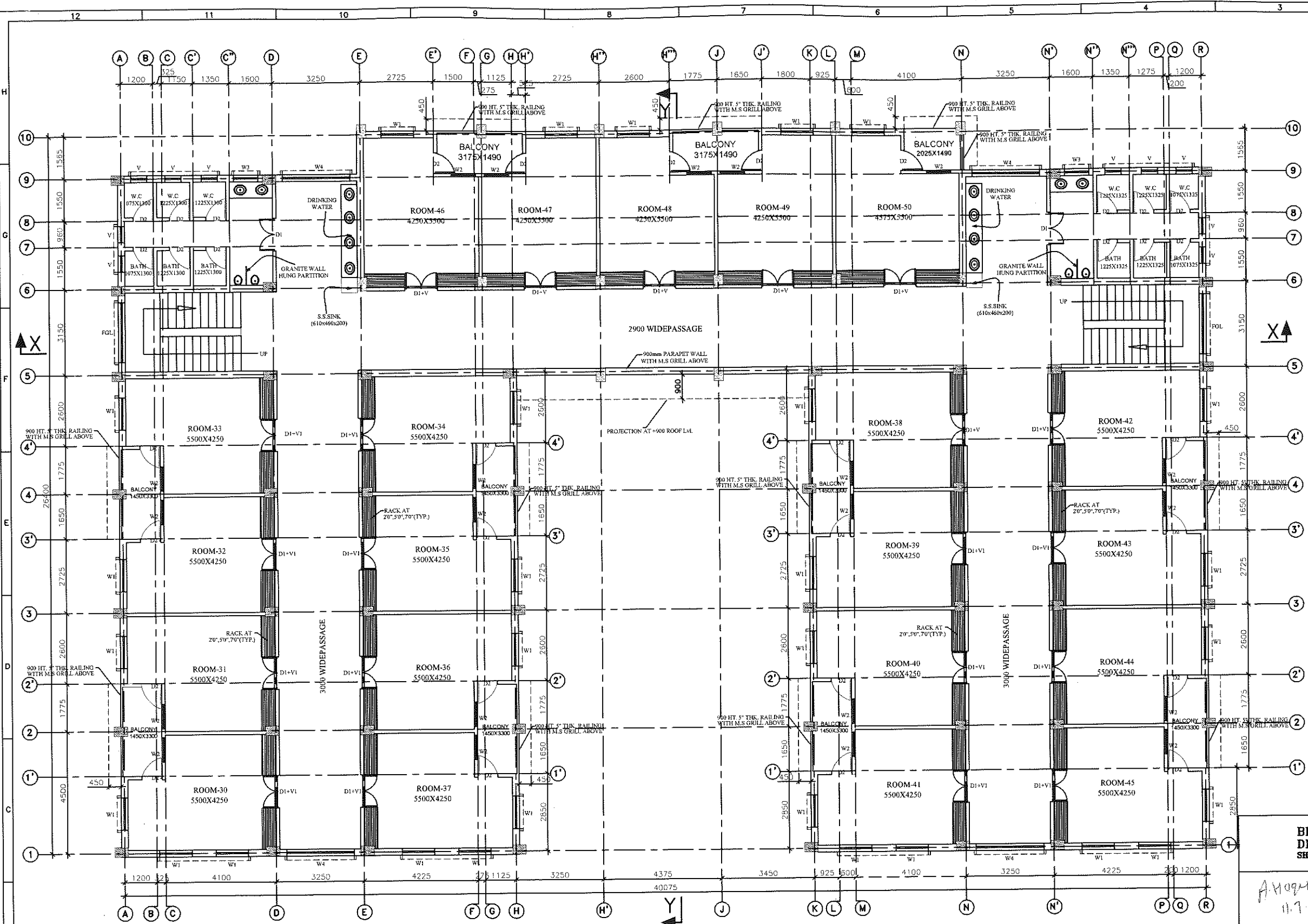

SECOND FLOOR PLAN  
 AREA - 858.80 sqm (9240.69 sqft.)  
 (SCALE 1:75)

*Drinking water provision done  
 Pantaj Gha  
 11.7.18*

BIHAR STATE EDUCATIONAL INFRASTRUCTURE  
 DEVELOPMENT CORPORATION LTD.  
 SHIKSHA BHAWAN, SAIDPUR, PATNA

<i>Ahmed</i> 11.7.18	ARCH. BSEIDC, PATNA	<i>Pantaj Gha</i> 11.7.18	C.E. BSEIDC, PATNA
DRAUGHTSMAN BSEIDC, PATNA		SENIOR (ARCH.) BSEIDC, PATNA	

PROJECT: PROPOSED CONSTRUCTION OF  
 BOY'S HOSTEL FOR 100 STUDENTS  
 (DIET, P.TEC, CTE, BITE)

DEPT.: BIHAR STATE EDUCATIONAL INFRASTRUCTURE  
 DEVELOPMENT CORPORATION LTD.  
 SHIKSHA BHAWAN, SAIDPUR, PATNA

ARCHT. AND CONSULTANT: **RDCS** RANCHI DESIGN & CONSULTANCY SERVICES PVT. LTD.  
 SOUTH OFFICE PARA, NEAR ST. XAVIER SCHOOL  
 DORANDA, RANCHI-834002

CHECKED & APPROVED	S.L. GOPE	<b>SECOND FLOOR PLAN</b>
DESIGN BY	S.A.	
DRAWN BY	J.P.	
SIZE-	SCALE 1:75	DRG. NO.-RDCS/BSEIDC/0033/HOS/001 SHEET 3 OF 4 REV R=2

- NOTES:-
- ALL DIMENSIONS AND LEVELS ARE IN mm. & FIGURED DIMENSIONS SHALL BE FOLLOWED.
  - ±0.00 LEVEL CORRESPONDS TO PLINTH LEVEL (P.L.) OF BUILDING. WHICH IS 600 ABOVE FINISHED GROUND LEVEL (G.L.).
  - ALL RCC WORK SHALL BE OF M25 GRADE CONCRETE.
  - BRICKWORK SHALL BE WITH 100A BRICKS IN CEMENT MORTAR 1:6.

REV.	DESCRIPTION	DATE	BY
△	GENERAL REVISION	26.11.14	SUNIL
△	GENERAL REVISION	29.04.14	J.P.